

levelling elements in cast iron
type V PHZ



levelling elements in cast iron version V PHZ

A combination of base in cast iron and levelling screw in version PHZ - pendulum action with cap nut. This version features two hexagonal spanner flats (at top and bottom of levelling screw) and angle compensation. Base in cast iron and cap nut are tightly connected.

standard colour of the base in cast iron: RAL 9006 white-aluminium
other colour tones according to RAL on request

optional: special electro-plating for the bases in cast iron and levelling screws in nickel or chrome, as well as stainless steel screws

levelling screws are supplied with the following accessories

2 x nut DIN 934 / ISO 4032
1 x washer DIN 125 / ISO 7089
1 x washer DIN 9021 / ISO 7093
from thread size M24 upwards
2 x nut DIN 934 / ISO 4032
2 x washer DIN 125 / ISO 7089

length specification h_2 of the levelling screw relates to the net thread length

assembly of the levelling screws with the nuts and washers, individual packaging of levelling elements in quick-lock mechanism bags and customized article labelling available at extra charge

schematic illustration version V PHZ

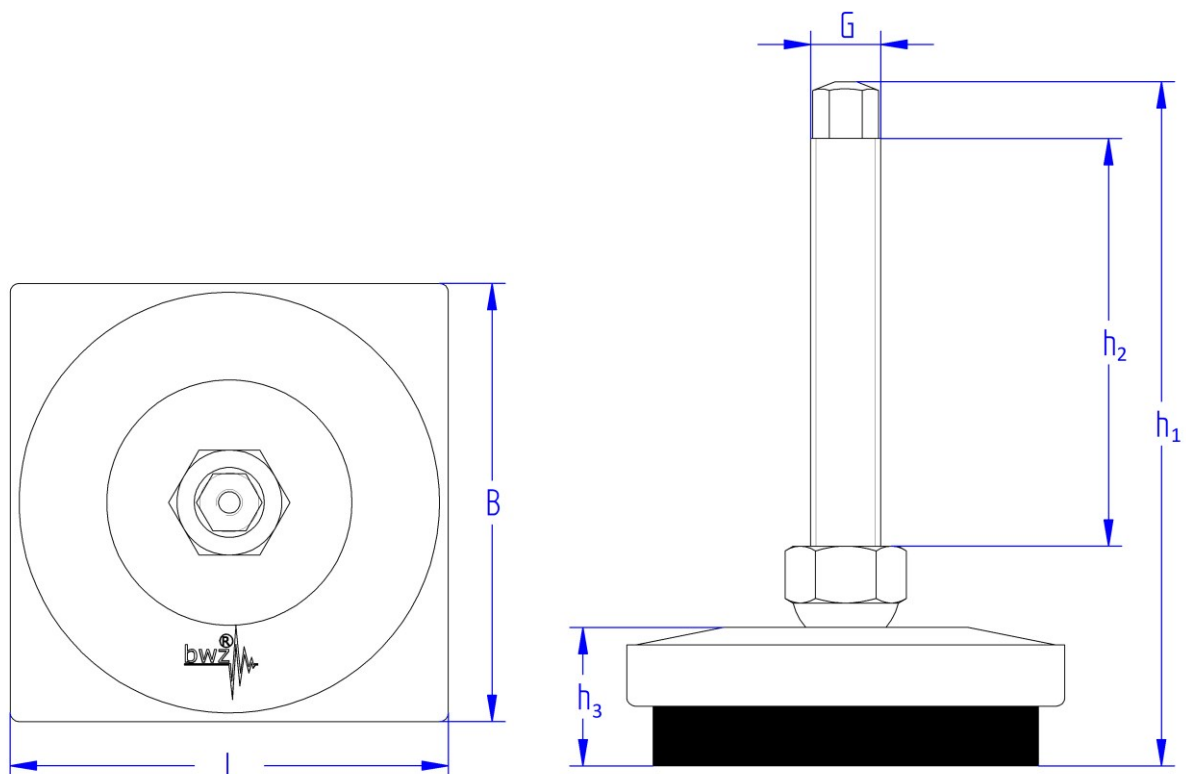

levelling elements in cast iron type V PHZ with elastomer NBR 5514

applications: passive isolation e.g. for metrology equipment, scales, dosage units and optical devices
 elastomer surface smooth, without tread pattern

type		L / B	h ₁	h ₂	h ₃	thread (G)	key width	spanner flat dimension	hardness	load
description	article number	mm	mm	mm	mm		bottom (mm)	top (mm)	±5 Shore	daN
7V PHZ NBR5514	7206 0001	85x85	143	92	23	M12	19	8x10	55	180
10V PHZ NBR5514	7216 0001	100x100	155	92	28	M16	24	12x14	55	300
12V PHZ NBR5514	7226 0001	126x126	158	92	31	M16	24	12x14	55	400
15V PHZ NBR5514	7236 0001	150x150	213	138	35	M20	30	14x16	55	700
17V PHZ NBR5514	7246 0001	178x178	214	138	37	M20	30	14x16	55	1000

levelling elements in cast iron type V PHZ with elastomer NBR 5518

applications: passive isolation e.g. for metrology equipment, scales, dosage units and optical devices
 elastomer surface with tread pattern - higher insulation effect as compared to type with NBR 5514

type		L / B	h ₁	h ₂	h ₃	thread (G)	key width	spanner flat dimension	hardness	load
description	article number	mm	mm	mm	mm		bottom (mm)	top (mm)	±5 Shore	daN
7V PHZ NBR5518	7206 0002	85x85	147	92	27	M12	19	8x10	55	180
10V PHZ NBR5518	7216 0002	100x100	159	92	32	M16	24	12x14	55	300
12V PHZ NBR5518	7226 0002	126x126	162	92	35	M16	24	12x14	55	400
15V PHZ NBR5518	7236 0002	150x150	217	138	39	M20	30	14x16	55	700
17V PHZ NBR5518	7246 0002	178x178	218	138	41	M20	30	14x16	55	1000

levelling elements in cast iron type V PHZ with elastomer NBR 7516

applications: damping / insulation e.g. for highly dynamic machinery, presses, shears, punches, compressors and pumps
 elastomer surface with tread pattern

type		L / B	h ₁	h ₂	h ₃	thread (G)	key width	spanner flat dimension	hardness	load
description	article number	mm	mm	mm	mm		bottom (mm)	top (mm)	±5 Shore	daN
7V PHZ NBR7516	7206 0003	85x85	144	92	24	M12	19	8x10	75	560
10V PHZ NBR7516	7216 0003	100x100	156	92	29	M16	24	12x14	75	800
12V PHZ NBR7516	7226 0003	126x126	159	92	32	M16	24	12x14	75	1200
15V PHZ NBR7516	7236 0003	150x150	215	138	37	M20	30	14x16	75	1800
17V PHZ NBR7516	7246 0003	178x178	216	138	39	M20	30	14x16	75	2800

levelling elements in cast iron type V PHZ with elastomer NBR 7525

applications: damping / insulation e.g. for highly dynamic machinery, presses, shears, punches, compressors and pumps
 elastomer surface with tread pattern - higher insulation / damping effect as compared to type with NBR 7516

type		L / B	h ₁	h ₂	h ₃	thread (G)	key width	spanner flat dimension	hardness	load
description	article number	mm	mm	mm	mm		bottom (mm)	top (mm)	±5 Shore	daN
7V PHZ NBR7525	7206 0004	85x85	154	92	34	M12	19	8x10	75	560
10V PHZ NBR7525	7216 0004	100x100	166	92	39	M16	24	12x14	75	800
12V PHZ NBR7525	7226 0004	126x126	169	92	42	M16	24	12x14	75	1200
15V PHZ NBR7525	7236 0004	150x150	224	138	46	M20	30	14x16	75	1800
17V PHZ NBR7525	7246 0004	178x178	225	138	48	M20	30	14x16	75	2800

levelling elements in cast iron type V PHZ with elastomer NBR 8516

applications: damping of e.g. general (CNC) machine tools, textile machines, graphic machines
and machines with horizontal thrust
elastomer surface with tread pattern

type		L / B	h ₁	h ₂	h ₃	thread (G)	key width	spanner flat dimension		hardness	load
description	article number	mm	mm	mm	mm		bottom (mm)	top (mm)	±5 Shore	daN	
7V PHZ NBR8516	7206 0005	85x85	144	92	24	M12	19	8x10	90	700	
10V PHZ NBR8516	7216 0005	100x100	156	92	29	M16	24	12x14	90	1000	
12V PHZ NBR8516	7226 0005	126x126	159	92	32	M16	24	12x14	90	1600	
15V PHZ NBR8516	7236 0005	150x150	215	138	37	M20	30	14x16	90	2300	
17V PHZ NBR8516	7246 0005	178x178	216	138	39	M20	30	14x16	90	3400	

levelling elements in cast iron type V PHZ with elastomer NBR 8525

applications: damping of e.g. general (CNC) machine tools, textile machines, graphic machines
and machines with horizontal thrust
elastomer surface with tread pattern - higher damping effect as compared to type with NBR 8516

type		L / B	h ₁	h ₂	h ₃	thread (G)	key width	spanner flat dimension		hardness	load
description	article number	mm	mm	mm	mm		bottom (mm)	top (mm)	±5 Shore	daN	
7V PHZ NBR8525	7206 0006	85x85	154	92	34	M12	19	8x10	90	700	
10V PHZ NBR8525	7216 0006	100x100	166	92	39	M16	24	12x14	90	1000	
12V PHZ NBR8525	7226 0006	126x126	169	92	42	M16	24	12x14	90	1600	
15V PHZ NBR8525	7236 0006	150x150	224	138	46	M20	30	14x16	90	2300	
17V PHZ NBR8525	7246 0006	178x178	225	138	48	M20	30	14x16	90	3400	

levelling elements in cast iron type V PHZ with elastomer NBR 9014

applications: damping of e.g. machining centres, transfer units, (CNC) machine tools, circular- and flat-grinding machines,
long-bedded machines with low intrinsic rigidity, drilling and milling devices
elastomer surface smooth, without tread pattern

type		L / B	h ₁	h ₂	h ₃	thread (G)	key width	spanner flat dimension		hardness	load
description	article number	mm	mm	mm	mm		bottom (mm)	top (mm)	±5 Shore	daN	
7V PHZ NBR9014	7206 0007	85x85	144	92	24	M12	19	8x10	90	700	
10V PHZ NBR9014	7216 0007	100x100	156	92	29	M16	24	12x14	90	1000	
12V PHZ NBR9014	7226 0007	126x126	159	92	32	M16	24	12x14	90	1600	
15V PHZ NBR9014	7236 0007	150x150	213	138	35	M20	30	14x16	90	2300	
17V PHZ NBR9014	7246 0007	178x178	214	138	37	M20	30	14x16	90	3400	

special screws

thread	
description	
M8 x 1,0 pitch	on request
M10 x 1,0 pitch	on request
M12 x 1,5 pitch	on request
M16 x 1,5 pitch	on request
M20 x 1,5 pitch	on request
M24 x 1,5 pitch	on request
M30 x 1,5 pitch	on request

Special thread lengths, alternative electro-plating with nickel or chrome, threads with special fine pitch, stainless steel levelling screws or special materials on request.

Custom solutions and modifications as per customer's request are possible any time, owing to our high internal manufacturing depth (CNC and conventional).

data on materials and tolerances

components in cast iron

according to DIN EN ISO 8062-3 DCTG 10 -/- manufacturing tolerance: according to ISO 2768-mk
materials: EN GJL 200 / EN GJL 250

elastomers

shore-hardness A measurement: according to DIN 53505 or rather DIN ISO 7619-1
tolerances for dimensions with tool-form based elastomer parts according to DIN ISO 3302-1, class M3
materials: NBR 55° / 75° / 90° ±5 shore A, dimensional tolerance ±1 mm

threads / levelling screws

according to DIN 976 -/- manufacturing tolerance: according to ISO 2768-mk
materials: steel blank 4.8 - steel zinc-coated 4.8 - stainless steel A2

manufacturing components from hexagonal bar material

according to EN 10277/10278 -/- manufacturing tolerance: according to ISO 2768-mk
materials: steel blank 11SMn30+C -/- stainless steel 1.4305

Technical modifications subject to change! Any previous versions of this document are herewith null and void!